

- Center is made of alloy steel under heating treatment to provide higher rigidity (HRC60°±2°) and satisfied wear-resistance.
- Center is constituted by ball bearings assembly.
- Applicable to middle-speed & high-speed lathe with light load.

Unit:mm

ORDER NO.	A	B	C	D	D1	L	Accuracy	Speed Max R.P.M.	θ	G.W. weight kgs	PACKING LxWxH	CODE NO.
VPC-MT1	21	31	56	32	16	108	0.005	3200	60°	0.3	115 x 136 x 38	5001-001
VPC-MT2	26	37	69	40	22	132	0.005	2800	60°	0.5	140 x 45 x 45	5001-002
VPC-MT3	32	46	86	45	26	164	0.005	2000	60°	0.9	170 x 50 x 52	5001-003
VPC-MT4	34	46	108	48	30	188	0.005	1800	60°	1.3	195 x 58 x 56	5001-004
VPC-MT5	50	62	136	68	45	248	0.005	1500	60°	3.2	268 x 86 x 77	5001-005



Live Lathe Center



A TYPE

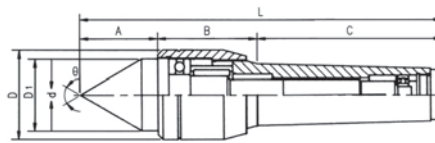

B TYPE

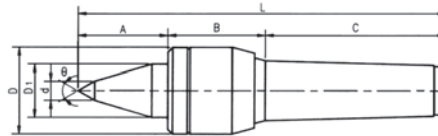

- Center shaft & main body are made of alloy steel under heating treatment to provide higher rigidity (HRC60°±2°) and satisfied wear-resistance.
- Center is constituted by thrust ball bearing, needle roller bearings & ball bearings assembly.
- Applicable to middle-speed & high-speed lathe with heavy load.
- ※ B TYPE SUITABLE FOR SMALL -WORKPIECE MACHINING.

Unit:mm

ORDER NO.	TYPE	A	B	C	D	D1	b	L	d1	Accuracy	Speed Max R.P.M.	θ	G.W. weight kgs	PACKING LxWxH	CODE NO.
VLC-212	MT2A	28	35	69	32	25	-	132	-	0.005	4000	60°	0.4	173 x 43 x 40	5001-010
VLC-213	MT3A	36	44	86	41	35	-	166	-	0.005	3000	60°	0.9	198 x 67 x 51	5001-011
VLC-214	MT4A	41	51	108	47	40	-	200	12	0.005	2500	60°	1.5	240 x 70 x 61	5001-012
VLC-215	MT5A	54	72	136	65	52	-	262	18	0.005	2000	60°	3.8	290 x 92 x 80	5001-013
VLC-213B	MT3B	46	44	86	41	25	10	176	-	0.005	3000	60°	0.9	198 x 67 x 51	5001-014
VLC-214B	MT4B	55	51	108	47	32	12	214	12	0.005	2500	60°	1.5	240 x 70 x 61	5001-015

THE CHART FOR LOADING WEIGHT WITH R.P.M.

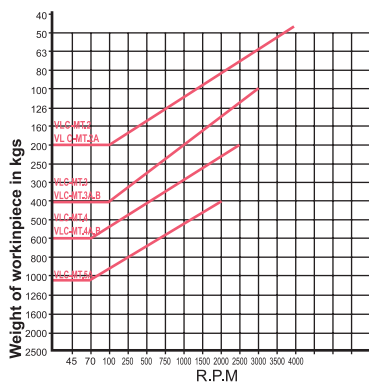

FOR VLC-TYPE

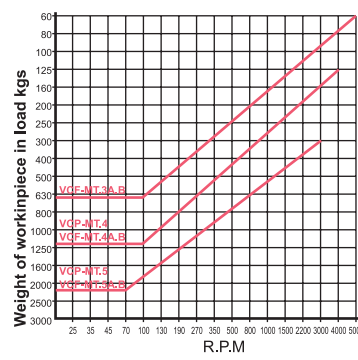

FOR VCF/VCP-TYPE

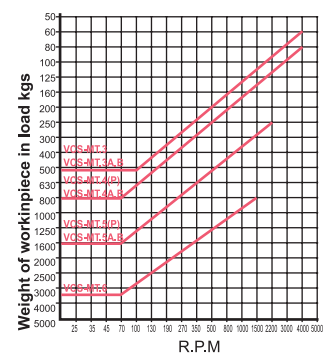

FOR VCS-TYPE



A TYPE

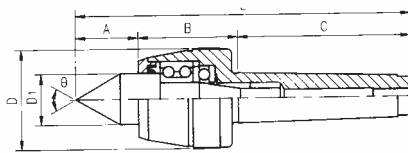

B TYPE

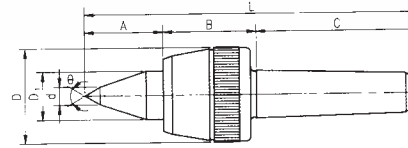

WATER-PROOF TYPE

- Center shaft is made of SKS3 material under vacuum heating treatment to provide higher rigidity (HRC60°±2°) and satisfied wear-resistance.
- Center is constituted by dual ball bearing. Thrust bearing & needle roller bearing assembly.
- Applicable to high-speed lathe & NC lathe with heavy load water-proof.
- ※ B Type is applicable in the metal workings on small workpieces.

Unit:mm

ORDER NO.	TYPE	A	B	C	D	D1	b	L	d1	Accuracy	Speed Max R.P.M.	θ	G.W. weight kgs	PACKING LxWxH	CODE NO.
VLC-MT3A	MT3A	39	55	86	53	30	-	180	12	0.005	4000	60°	1.3	240 x 70 x 61	5001-020
VLC-MT4A	MT4A	42	62	108	63	32	-	212	12	0.005	3000	60°	2.2	253 x 92 x 80	5001-021
VLC-MT5A	MT5A	57	71	136	83	40	-	264	18	0.005	2500	60°	4.5	303 x 108 x 101	5001-022
VLC-MT6A	MT6A	80	115	139	128	70	-	384	-	0.008	1500	60°	15.6	410 x 177 x 168	5001-023
VLC-MT3B	MT3B	45	55	86	53	30	10	186	12	0.005	4000	60°	1.4	240 x 70 x 61	5001-024
VLC-MT4B	MT4B	52	62	108	63	32	12	222	12	0.005	3000	60°	2.2	253 x 92 x 80	5001-025
VLC-MT5B	MT5B	67	71	136	83	40	14	274	18	0.005	2500	60°	4.5	303 x 108 x 101	5001-026



High-Load NC Live Center



A TYPE

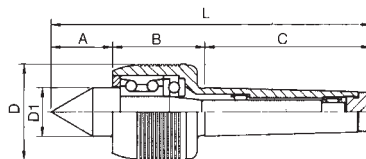

B TYPE

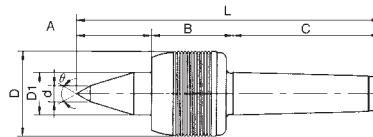

- Shaft uses material SKD11: through vacuum heat treatment, it is even more durable, hardness is as high as (HRC60°±2°) and satisfied wear-resistance. Main body is made of SCM21 material.
- Front end is constituted by SKF angular contact ball bearing & thrust ball bearing. middle & rear ends are comprised of needle roller bearing assembly.
- These centers are suitable for NC lathe at high-speed & heavy-load operation, water-proof.
- ※ B Type is applicable in the metal workings on small workpieces.

Unit:mm

ORDER NO.	A	B	C	D	D1	b	L	d1	Accuracy	Speed Max R.P.M.	θ	G.W. weight kgs	PACKING LxWxH	CODE NO.
VCF-MT3A	38	50	86	53	30	-	174	12	0.003	5000	60°	1.3	240 x 70 x 61	5001-030
VCF-MT4A	45	60	108	68	32	-	213	12	0.003	4500	60°	2.4	253 x 92 x 80	5001-031
VCF-MT5A	52	70	136	87	40	-	258	18	0.003	3000	60°	5	303 x 108 x 101	5001-032
VCF-MT3B	52	50	86	53	25	10	188	12	0.003	5000	60°	1.3	240 x 70 x 61	5001-033
VCF-MT4B	55	60	108	68	32	12	223	12	0.003	4500	60°	2.4	253 x 92 x 80	5001-034
VCF-MT5B	67	70	136	87	40	14	273	18	0.003	3000	60°	5	303 x 108 x 101	5001-035



- Complete set with 7 Interchangeable Points for various processing.
- Packed in plastic case.
- Accurating high accuracy and durability as well as complete rust-proof performance
- Body mabe of SCM-4 special tool steel hardened and ground can be used for heavy duty work.

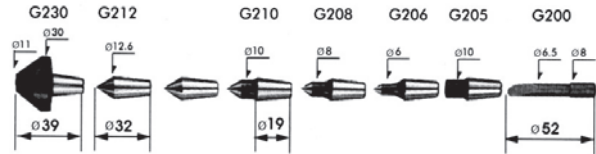
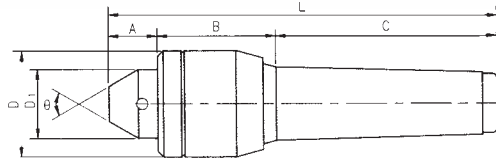

Unit:mm

ORDER NO.	TYPE	A	B	C	D	D1	b	L	d1	Accuracy	Speed Max R.P.M.	θ	G.W. weight kgs	PACKING LxWxH	CODE NO.
VLC-312	MT2	22	36	69	32	25	-	127	-	0.008	4000	60°	0.9	166 x 105 x 63	5001-040
VLC-313	MT3	23	44	86	41	30	-	153	-	0.008	3000	60°	1.4	255 x 138 x 100	5001-041
VLC-314	MT4	23	51	108	47	32	-	182	-	0.008	2500	60°	2	255 x 138 x 100	5001-042



High Speed NC Interchangeable Points Live Center

Water-Proof Type



- Center shaft is made of SKS3 material under vacuum heating treatment to provide higher rigidity (HRC60°±2°) and satisfied wear-resistance.
- Center is constituted by dual ball bearing. Thrust bearing & needle roller bearing assembly.
- Applicable to high-speed lathe & NC leathe with heavy load, water-proof.

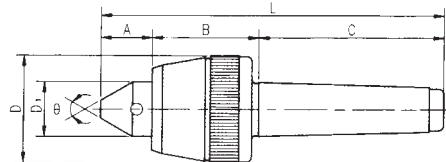

VCS-MT3, MT4

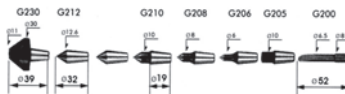

VCS-MT4P, MT5P

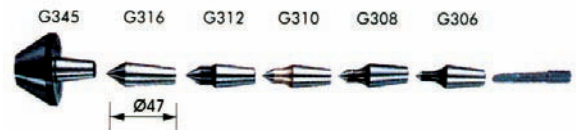

Unit:mm

ORDER NO.	A	B	C	D	D1	b	L	d1	Accuracy	Speed Max R.P.M.	θ	G.W. weight kgs	PACKING LxWxH	CODE NO.
VCS-MT3	28	55	86	53	30	-	167	-	0.008	4000	60°	1.8	255 x 138 x 100	5001-050
VCS-MT4	30	62	108	63	32	-	196	-	0.008	3500	60°	2.5	255 x 138 x 100	5001-051
VCS-MT4P	30	62	108	63	32	-	196	-	0.008	3500	60°	2.7	235 x 130 x 80	5001-052
VCS-MT5P	34	71	136	83	40	-	237	-	0.008	2500	60°	5.1	275 x 147 x 97	5001-053



- Shaft uses material SKD11:through vacuum heat treatment, it is even more durable, hardness is as high as (HRC60°±2°) and satisfied wear-resistance. Main body is made of SCM21 material.
- Front end is constituted by skf angular contact ball bearing & thrust ball bearing. middle & rear ends are comprised of needle roller bearing assembly.
- These centers are suitable for NC lathe at high-speed & heavy-load operation, water-proof.

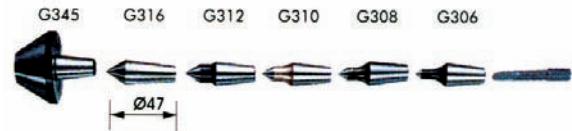
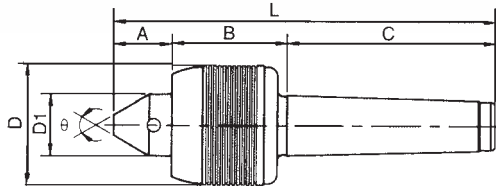

Unit:mm

ORDER NO.	A	B	C	D	D1	b	L	d1	Accuracy	Speed Max R.P.M.	θ	G.W. weight kgs	PACKING LxWxH	CODE NO.
VCP-MT4	35	60	108	68	32	-	203	-	0.005	4500	60°	3	253 x 130 x 80	5001-060
VCP-MT5	37	70	136	87	40	-	243	-	0.005	3000	60°	5.5	275 x 147 x 97	5001-061



Bull Nose Center

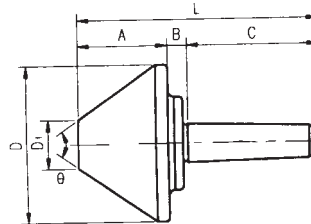

HARDEN PROCESS : HRC50°
 CONCENTRICITY : 0.005mm
 ROUNDNESS : 0.005mm
 MATERIAL : STEEL

Unit:mm

ORDER NO.	SIZE	A	C	D	D1	L	Speed Max R.P.M.	R.P.M.100 LOAD WEIGHT (KGS)	G.W. weight (KGS)	CODE NO.
VLC-433	MT3x3"	52	86	78	15	156	3300	400	1.6	5001-070
VLC-434	MT3x4"	59	86	106	25	161	3000	500	2.8	5001-071
VLC-443	MT4x3"	52	108	78	15	178	3300	400	1.8	5001-072
VLC-444	MT4x4"	59	108	106	25	183	3000	500	3.1	5001-073
VLC-445	MT4x5"	73	108	128	40	193	2000	650	4.9	5001-074

Unit:mm

ORDER NO.	SIZE	A	C	D	D1	L	Speed Max R.P.M.	R.P.M.100 LOAD WEIGHT (KGS)	G.W. weight (KGS)	CODE NO.
VLC-446	MT4x6"	88	108	156	45	208	1900	800	7.7	5001-075
VLC-448	MT4x8"	98	108	206	81	218	1500	1300	15.4	5001-076
VLC-455	MT5x5"	73	136	128	40	221	2000	650	5.8	5001-077
VLC-456	MT5x6"	88	136	156	45	236	1900	800	8.6	5001-078
VLC-458	MT5x8"	98	136	206	81	246	1500	1600	15.7	5001-079

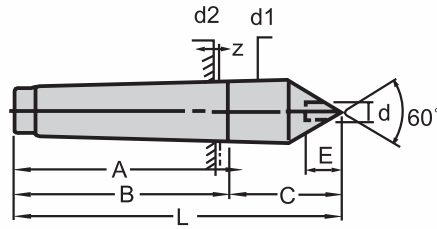

- Carbide tipped-HRC 70°
- Hardened & precision ground.
- Concentricity within .0002" (0.005mm)

Unit:mm

ORDER NO.	SIZE	L	A	B	C	E	d2	d1	d	WEIGHT (KGS)	CODE NO.
VLC-112	MT-2	100	69	67	31	8	17.780	18.0	6	0.2	5001-090
VLC-113	MT-3	125	89	81	39	10	23.825	24.1	8	0.4	5001-091
VLC-114	MT-4	155	109	102.5	46	14	31.267	31.6	10	0.8	5001-092
VLC-115	MT-5	200	136	129.5	64	18	44.399	44.7	14	2.1	5001-093
VLC-116	MT-6	270	190	182	80	30	63.648	63.8	18	5.7	5001-094



Work-Driving Center



VDK-15



VDK-23



VDK-32

- This Clamp-free center is comprised of excellent mechanical structure, nearly free of breakdown. main body & center shaft are made of SLD material under heating treatment(HRC62°).
- Driving is required for traditional lathe machining to prevent workpiece from stop. This clamp-free center with 6 T & 8 T design on end surface is able to securely support workpiece surface to fulfill easy and rapid machining.

Unit:mm

ORDER NO.	Center Shaft Size	Outer Dia	Working Range	Weight (KGS)	CODE NO.
VDK-15-MT4	6ø	16ø	16ø-25ø	0.6	5001-100
VDK-23-MT4	8ø	23ø	23ø-32ø	0.7	5001-101
VDK-32-MT4	8ø	32ø	32ø-45ø	0.7	5001-102



Work-Driving Center-Changable Tips

SET STYLE



TAPER SLEEVE



STOPPER



CENTER

Unit:mm

ORDER NO.	Center Shaft Size	Stopper Outer Dia	Working Range	Weight (KGS)	CODE NO.
VDC-30-MT4	6ø, 8ø, 10ø	16ø, 23ø, 30ø	15ø-45ø	0.23	5001-106